

1100 SERIES COMBINATION SLAB SAWS

QTY	PART #	DESCRIPTION
1	1	TANK
2	2	HANDLE
4	3	8-32 X 3/8 FHMS, WASHER & NUT
1	5	PLASTIC HOOD/LID
1	6	MAGNET & (2) 6-32 X 1/2" RHMS & NUT
1	7	MOTOR (MTR199)
1	8	MOTOR PULLEY
1	9	1/4"-20 X 1-1/4" RHMS, (4) WASHERS & (3) NUTS
4	10	PLASTIC RING
1	11	1/2"-20 X 3/4" RHMS, WASHER & NUT
1	12	BELT GUARD
1	13	1/4" FENDER WASHER
1	14	1/4"-20 WING NUT
1	15	V-BELT
2	16	1/4"-20 NUT, LOCK WASHER & WASHER
1	17	ARBOR PULLEY
1	18	1/4"-20 X 2-1/2" RHMS & FIBER WASHER
1	19	3/8" PIPE PLUG



1100 SERIES

COMBINATION SLAB SAWS

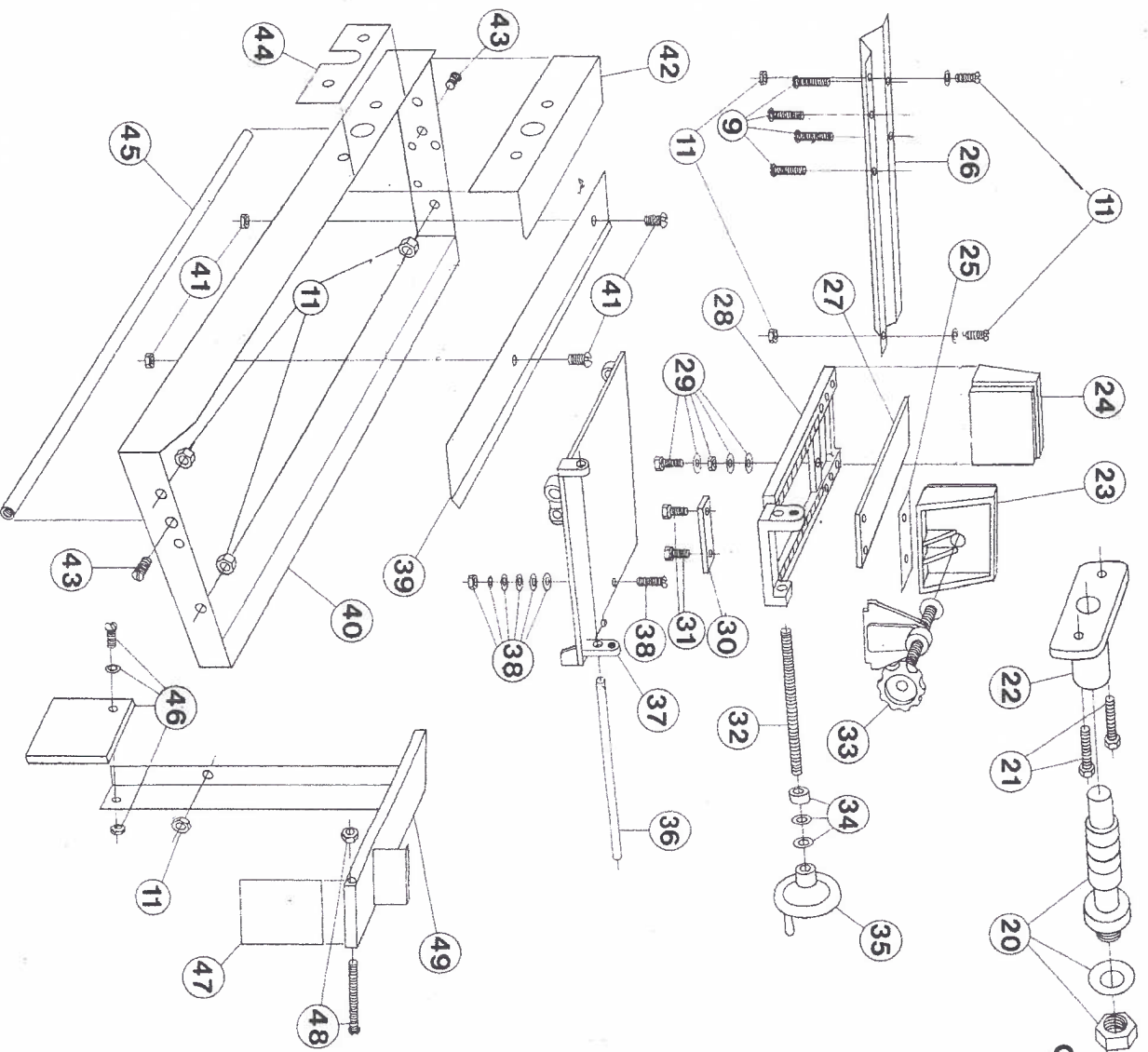

QTY	PART #	DESCRIPTION
1	20	ARBOR BEARING, 2" 5/8" FLANGE & 5/8"-18 NUT
1	21	(2) CARRIAGE BOLTS FOR ARBOR
1	22	ARBOR HOUSING (CASTING #69)
1	23	FRONT VISE (CASTING #104)
1	24	BACK VISE (CASTING #104)
1	25	SHIM
1	26	MOTOR MOUNT BRACE
1	27	VISE BAR
1	28	VISE SLIDE (CASTING #104)
1	29	1/4"-20 X 1/2" HHMS, (3) 1/4" X 1-1/2" FENDER WASHER & NUT
1	30	VISE BAR CLAMP
2	31	1/4"-20 X 1" HHMS
1	32	3/8"-16 X 1 1/2" THREADED ROD
1	33	VISE ADJUSTMENT ASSEMBLY
2	34	3/8"-16 JAM NUT & FIBER WASHER
1	35	3" X 3/8" SPIN HANDLE
1	36	1/2" X 10-1/4" VISE CROSS SHAFT
1	37	VISE CARRIAGE (CASTING #13)
1	38	1/4"-20 THMS, FENDER WASHERS, LOCK WASHER, & NUT
1	39	ROCK CATCHER
1	40	FRAME
2	41	1/4"-20 X 1/2" THMS & NUT
1	42	ARBOR SHIELD
1	43	1/4"-20 X 5/8" FHMS
2	44	CORK ARBOR GASKET
1	45	3/4" X 29" CARRIAGE SUPPORT ROD
1	46	CARPET PAD, 8-32 X 3/8" THMS, WASHER, LOCKWASHER & NUT
1	47	PLASTIC CURTAIN
1	48	8-32 X 3-5/8" RHMS & LOCKNUT
1	49	BLADE GUARD